

engage HUB SOLO



REDUCE **MONITOR** SAVE



LOCATE THE LIVE FEED CABLE

Open the panel and place the current sensor around the main feed wire of your fusebox or electricity panel (see the next step for details on installing a CT sensor).

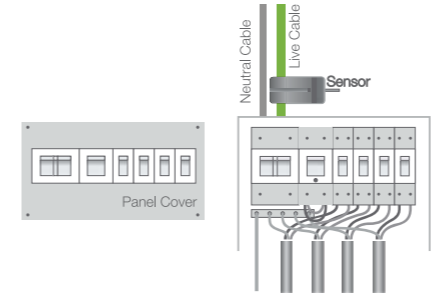

ATTACH THE SENSOR

Pull the clasp to open the CT sensor. Place the sensor around the feed cable and push the clasp to shut. Insert the sensor jack in to the base of the transmitter.

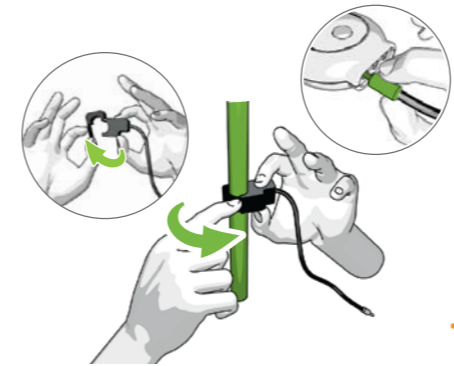

1

CONNECTING THE ENGAGE HUB

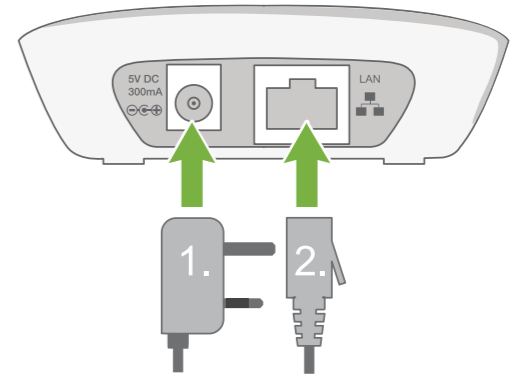

1. Connect the AC/DC adaptor to engage hub. A red LED light will indicate power is being supplied to the hub.
2. Connect the engage Hub to your home broadband router with the ethernet cable provided.

2

SETTING UP THE ONLINE SERVICE

Visit <http://engage.efergy.com>, sign up and follow our 3 step setup process on-screen. To register your device you will need to input your MAC address which can be found on the underside of the engage hub.



LINKING THE TRANSMITTER

When prompted by the on-screen instructions, complete installation by pressing Link button on your transmitter. Please make sure your transmitter has been installed within range of your hub (40-70m). If the green device status indicator has not appeared on-screen within one minute of pressing the link button please try pressing it again.



3

WHAT'S IN THE BOX

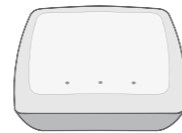

1x engage hub



1x Ethernet Cable



AC/DC Adaptor

TECHNICAL INFORMATION

Model Name	engage hub
Model Number	HH-1.0
Frequency	433.5MHz
Transmission Time	6, 12, or 18 Sec.
Transmission Range	40 - 70m
Home Hub Power	AC/DC Adaptor



4

ASK ROGER

If you have any questions about using your installation guide or want further information on saving energy, you can contact Roger or visit our website. We aim to answer all your emails within 48 hours.

askroger@efergy.com

Tel : +44 (0)1143 272 646

www.efergy.com
www.efergy.eu



CE RoHS



5600